

AMD1 Series

Traditional Post Top Luminaire



Complete Light Pole Shown Above:
CL10F-AMD1

SPECIFICATIONS

Post Top

Height: 38.5 Width: 16"

Globe

Acrylic globe. High impact strength, UV stabilized, and shatterproof material.

Casting

Cast Aluminum Globeholder and base with super durable powder coat finish.

Post Top EPA

1.588 (ft²)

Fasteners

Stainless Steel Fasteners Standard

Mounting

Post-top is secured to pole/tenon with 4x stainless steel set screws. All lighting bases and poles are surface mount and include a template and anchor bolts.

Pole

Fits all Brandon Industries 3" and 4" poles. Fits all 5" poles with a tenon. All pole heights are dependent on base selection. Refer to Base and Pole chart for exact heights.

Finish

Finished with Super Durable Tiger Drylac Powder Coat. TIGER Drylac Series 38 complies with AAMA 2604*. TIGER Drylac Series 38 are weather and UV resistant and can withstand long exposure to harsh environments.

Warranty

LED Components - 5 Years
Aluminum Castings - 1 Year

ORDERING

CL1-0-F-AMD1-CC-18W-3000K-V-BK-P

BASE SERIES	POLE HEIGHT *	POLE	POST TOP	
SEE PAGE 2 FOR BASE DETAILS	SEE PAGE 2 FOR EXACT POLE HEIGHTS	F Fluted S Smooth	AMD1	
CL1	0			
CL2	1			
CL5	2			
CL6	3			
CL7	4			
CL8	5			
LAMP TYPE	OPTICS	WATTAGE	VOLTAGE	CCT
			SV	
INT Integrated LED	TYPE III	30W 50W	SV 100-277V	30 3000K 40 4000K 50 5000K
CC Removable LED Bulb	TYPE III	18W 27W 36W 54W		
MED Medium Socket Only	LEAVE BLANK	LEAVE BLANK		
MOG Mogul Socket Only				
FINISH	MOUNTING	OPTIONS		
BK Black	POLE/TENON	PC Photocell	HSS House Side Shield	
DB Dark Bronze		10KV Surge Protection	HV 480V	
GN Dark Green		20KV Surge Protection	CD Custom Design	
VG Verde Green		DIM Dimmable Driver	Including Color, Decorative Trims, and CCT Available. Contact Factory for Pricing & Lead Times.	

ENERGY CHART

LAMP TYPE	WATTAGE	LUMEN	LM/W
INT	30W	3,300	110lm/w
INT	50W	5,500	110lm/w
CC	18W	2,520	140lm/w
CC	27W	3,800	140lm/w
CC	36W	5,000	140lm/w
CC	54W	7,600	140lm/w

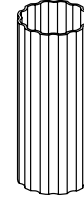
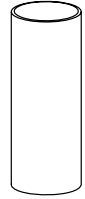
POLE OPTIONS

FLUTED

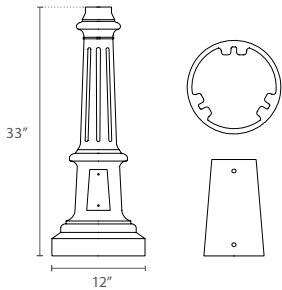
SMOOTH
OVERALL COMPLETE UNIT HEIGHT

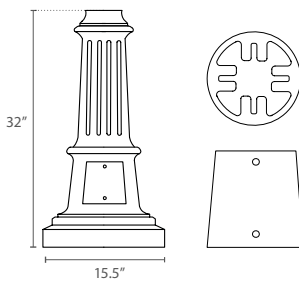
BASE	CL1	CL2	CL5	CL6	CL7	CL8
POLE DIAMETER	3"	4"	4"	4"	5"	4"
BASE & POLE HEIGHTS	0	9'4"	10'4"	9'8"	9'10"	9'9"
	1	10'4"	11'4"	10'8"	10'10"	10'9"
	2	11'4"	12'4"	11'8"	11'10"	11'9"
	3	12'4"	13'4"	12'8"	12'10"	12'9"
	4	13'4"	14'4"	13'8"	13'10"	13'9"
5	14'4"	15'4"	14'8"	14'10"	14'9"	14'4"

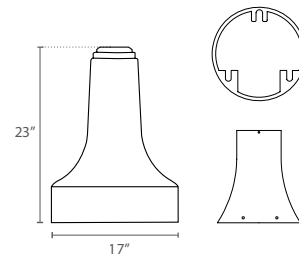
BASE OPTIONS

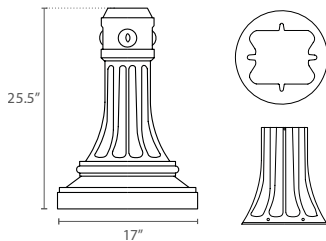
CL1

 Qty. (3) – 1/2" Anchor Bolts
 Access Door – 5.5" tall x 4" wide

CL2

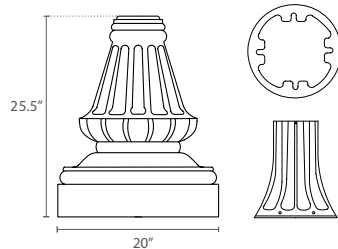
 Qty. (4) – 3/4" Anchor Bolts
 Access Door – 5" tall x 6" wide

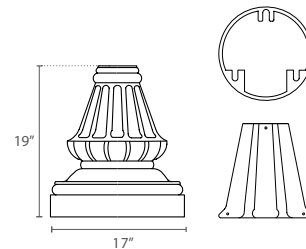
CL5

 Qty. (3) – 3/4" Anchor Bolts
 Access Door – 9" tall x 9" wide

CL6

 Qty. (4) – 3/4" Anchor Bolts
 Access Door – 9.5" tall x 11" wide

CL7

 Qty. (4) – 3/4" Anchor Bolts
 Access Door – 9.5" tall x 9" wide

CL8

 Qty. (3) – 3/4" Anchor Bolts
 Access Door – 7" tall x 7" wide

EPA DATA - POLE AND BASE

Maximum Allowable Effective Projected Area (EPA) for wind speed with 3-second gust.

PRODUCT	BASE			ANCHOR		POLE			MAX EPA - POST TOP FIXTURE (FT ²) WIND SPEED - MPH								
	H	Hgt	Dia	Qty	Dia	OD	Wall	Length	105	110	120	130	140	150	160	170	180
CL1 FLUTED POLE																	
CL10F	9'4"	33"	12"	3	1/2"	3"	0.125	7'0"	4.32	3.87	3.13	2.56	2.10	1.74	1.44	1.19	0.98
CL11F	10'4"	33"	12"	3	1/2"	3"	0.125	8'0"	3.63	3.23	2.57	2.06	1.66	1.33	1.06	0.84	0.66
CL12F	11'4"	33"	12"	3	1/2"	3"	0.125	9'0"	3.05	2.69	2.10	1.64	1.27	0.98	0.74	0.54	0.37
CL13F	12'4"	33"	12"	3	1/2"	3"	0.125	10'0"	2.55	2.22	1.68	1.27	0.93	0.66	0.44	0.26	0.11
CL14F	13'4"	33"	12"	3	1/2"	3"	0.125	11'0"	2.11	1.81	1.31	0.93	0.62	0.38	0.18	0.01	
CL15F	14'4"	33"	12"	3	1/2"	3"	0.125	12'0"									
CL2 FLUTED POLE																	
CL20F	10'4"	32"	12"	4	1/2"	4"	0.125	8'0"	7.73	6.93	5.64	4.63	3.83	3.18	2.65	2.22	1.85
CL21F	11'4"	32"	12"	4	1/2"	4"	0.125	9'0"	6.68	5.96	4.79	3.88	3.16	2.57	2.10	1.70	1.37
CL22F	12'4"	32"	12"	4	1/2"	4"	0.125	10'0"	5.78	5.13	4.06	3.23	2.57	2.04	1.61	1.25	0.95
CL23F	13'4"	32"	12"	4	1/2"	4"	0.125	11'0"	5.00	4.40	3.42	2.66	2.05	1.57	1.17	0.84	0.56
CL24F	14'4"	32"	12"	4	1/2"	4"	0.125	12'0"	4.31	3.75	2.85	2.14	1.59	1.13	0.77	0.46	0.20
CL25F	15'4"	32"	12"	4	1/2"	4"	0.125	13'0"	3.69	3.17	2.33	1.68	1.16	0.74	0.39	0.11	
CL5 FLUTED POLE																	
CL50F	9'8"	23"	17"	3	3/4"	4"	0.125	8'0"	7.63	6.89	5.60	4.60	3.80	3.16	2.63	2.19	1.83
CL51F	10'8"	23"	17"	3	3/4"	4"	0.125	9'0"	6.57	5.92	4.76	3.85	3.13	2.55	2.08	1.68	1.35
CL52F	11'8"	23"	17"	3	3/4"	4"	0.125	10'0"	5.67	5.10	4.03	3.21	2.55	2.02	1.59	1.23	0.93
CL53F	12'8"	23"	17"	3	3/4"	4"	0.125	11'0"	4.89	4.37	3.40	2.64	2.03	1.55	1.15	0.82	0.54
CL54F	13'8"	23"	17"	3	3/4"	4"	0.125	12'0"	4.20	3.73	2.83	2.12	1.57	1.12	0.75	0.44	0.19
CL55F	14'8"	23"	17"	3	3/4"	4"	0.125	13'0"	3.59	3.15	2.31	1.66	1.14	0.72	0.38	0.09	
CL6 FLUTED POLE																	
CL60F	9'10"	25.5"	17"	4	3/4"	4"	0.125	8'0"	7.68	6.89	5.60	4.60	3.80	3.16	2.63	2.19	1.83
CL61F	10'10"	25.5"	17"	4	3/4"	4"	0.125	9'0"	6.64	5.92	4.76	3.85	3.13	2.55	2.08	1.68	1.35
CL62F	11'10"	25.5"	17"	4	3/4"	4"	0.125	10'0"	5.74	5.10	4.03	3.21	2.55	2.02	1.59	1.23	0.93
CL63F	12'10"	25.5"	17"	4	3/4"	4"	0.125	11'0"	4.97	4.37	3.40	2.64	2.03	1.55	1.15	0.82	0.54
CL64F	13'10"	25.5"	17"	4	3/4"	4"	0.125	12'0"	4.28	3.73	2.83	2.12	1.57	1.12	0.75	0.44	0.19
CL65F	14'10"	25.5"	17"	4	3/4"	4"	0.125	13'0"	3.66	3.15	2.31	1.66	1.14	0.72	0.38	0.09	
CL7 FLUTED POLE																	
CL70F	9'10"	24"	20"	4	3/4"	5"	0.188	8'0"	17.19	15.53	12.81	10.69	9.01	7.65	6.54	5.62	4.85
CL71F	10'10"	24"	20"	4	3/4"	5"	1.188	9'0"	15.17	13.66	11.20	9.29	7.77	6.54	5.54	4.71	4.01
CL72F	11'10"	24"	20"	4	3/4"	5"	2.188	10'0"	13.46	12.09	9.84	8.09	6.71	5.59	4.67	3.91	3.28
CL73F	12'10"	24"	20"	4	3/4"	5"	3.188	11'0"	11.99	10.73	8.66	7.05	5.78	4.75	3.91	3.21	2.63
CL74F	13'10"	24"	20"	4	3/4"	5"	4.188	12'0"	10.70	9.53	7.62	6.14	4.96	4.00	3.22	2.58	2.04
CL75F	14'10"	24"	20"	4	3/4"	5"	5.188	13'0"	9.56	8.47	6.70	5.31	4.21	3.33	2.60	2.00	1.50
CL8 FLUTED POLE																	
CL80F	9'4"	19"	17"	3	3/4"	4"	0.125	8'0"	7.63	6.85	5.56	4.56	3.77	3.13	2.60	2.17	1.81
CL81F	10'4"	19"	17"	3	3/4"	4"	0.125	9'0"	6.60	5.89	4.73	3.82	3.11	2.53	2.05	1.66	1.33
CL82F	11'4"	19"	17"	3	3/4"	4"	0.125	10'0"	5.71	5.06	4.01	3.18	2.53	2.00	1.57	1.21	0.91
CL83F	12'4"	19"	17"	3	3/4"	4"	0.125	11'0"	4.94	4.34	3.37	2.61	2.01	1.53	1.13	0.80	0.53
CL84F	13'4"	19"	17"	3	3/4"	4"	0.125	12'0"	4.25	3.70	2.80	2.10	1.55	1.10	0.73	0.43	0.17
CL85F	14'4"	19"	17"	3	3/4"	4"	0.125	13'0"	3.64	3.13	2.29	1.64	1.12	0.70	0.36	0.08	

NOTES

- The pole material is aluminum extrusion per ASTM B221 alloy 6005 Temper T5 (35 ksi yield strength min, 15 ksi at welds per Table A.3.5 of the Aluminum Design Manual, 2010).
- The pole is welded onto a cast aluminum base. Construction of the pole is continuous, with the exception of AB4, which requires a hand hole.
- The maximum allowable EPA for signage is derived from:
 - The maximum allowable bending stress at the welded joint between the pole and the base,
 - The maximum deflection at the top end of the pole being $\leq 5\%$ of the exposed pole length with a 100-lb force applied at the top of pole, and
 - The projected area of pole and sign combined.
- The geometric center of the light fixture area is along the centerline of the light pole (i.e. symmetric wind loading) and centered at height, H plus half of the fixture height, above the ground.
- The fixture is defined as the structure mounted to the top of the light pole.
- The fixture height is assumed to be 38 in.
- Pole bases and anchorage are to be engineered by others.
- Reference ASCE 7-10 for wind forces. Exposure C category. Consult ASCE 7-10 for basic wind speeds in the desired site locations.
- The lights are not located near ridges, escarpments, or axisymmetric hills. Consult with an engineer for these applications.
- Local codes and standards applied by others.
- View the wind zone map of the US here: BrandonIndustries.com/EPA-Wind/

EPA DATA - POLE AND BASE

Maximum Allowable Effective Projected Area (EPA) for wind speed with 3-second gust.

PRODUCT	BASE			ANCHOR		POLE			MAX EPA - POST TOP FIXTURE (FT ²) WIND SPEED - MPH								
	H	Hgt	Dia	Qty	Dia	OD	Wall	Length	105	110	120	130	140	150	160	170	180
CL1 SMOOTH POLE																	
CL10S	9'4"	33"	12"	3	1/2"	3"	0.125	7'0"	4.52	4.05	3.29	2.69	2.22	1.84	1.53	1.27	1.05
CL11S	10'4"	33"	12"	3	1/2"	3"	0.125	8'0"	3.81	3.40	2.71	2.18	1.76	1.42	1.14	0.91	0.72
CL12S	11'4"	33"	12"	3	1/2"	3"	0.125	9'0"	3.22	2.84	2.22	1.75	1.37	1.06	0.81	0.60	0.43
CL13S	12'4"	33"	12"	3	1/2"	3"	0.125	10'0"	2.70	2.36	1.80	1.36	1.02	0.74	0.51	0.32	0.16
CL14S	13'4"	33"	12"	3	1/2"	3"	0.125	11'0"	2.25	1.93	1.42	1.02	0.70	0.44	0.24	0.06	
CL15S	14'4"	33"	12"	3	1/2"	3"	0.125	12'0"									
CL2 SMOOTH POLE																	
CL20F	10'4"	32"	12"	4	1/2"	4"	0.125	8'0"	7.73	6.93	5.64	4.63	3.83	3.18	2.65	2.22	1.85
CL21F	11'4"	32"	12"	4	1/2"	4"	0.125	9'0"	6.68	5.96	4.79	3.88	3.16	2.57	2.10	1.70	1.37
CL22F	12'4"	32"	12"	4	1/2"	4"	0.125	10'0"	5.78	5.13	4.06	3.23	2.57	2.04	1.61	1.25	0.95
CL23F	13'4"	32"	12"	4	1/2"	4"	0.125	11'0"	5.00	4.40	3.42	2.66	2.05	1.57	1.17	0.84	0.56
CL24F	14'4"	32"	12"	4	1/2"	4"	0.125	12'0"	4.31	3.75	2.85	2.14	1.59	1.13	0.77	0.46	0.20
CL25F	15'4"	32"	12"	4	1/2"	4"	0.125	13'0"	3.69	3.17	2.33	1.68	1.16	0.74	0.39	0.11	
CL5 SMOOTH POLE																	
CL50S	9'8"	23"	17"	3	3/4"	4"	0.125	8'0"	7.63	6.89	5.60	4.60	3.80	3.16	2.63	2.19	1.83
CL51S	10'8"	23"	17"	3	3/4"	4"	0.125	9'0"	6.57	5.92	4.76	3.85	3.13	2.55	2.08	1.68	1.35
CL52S	11'8"	23"	17"	3	3/4"	4"	0.125	10'0"	5.67	5.10	4.03	3.21	2.55	2.02	1.59	1.23	0.93
CL53S	12'8"	23"	17"	3	3/4"	4"	0.125	11'0"	4.89	4.37	3.40	2.64	2.03	1.55	1.15	0.82	0.54
CL54S	13'8"	23"	17"	3	3/4"	4"	0.125	12'0"	4.20	3.73	2.83	2.12	1.57	1.12	0.75	0.44	0.19
CL55S	14'8"	23"	17"	3	3/4"	4"	0.125	13'0"	3.59	3.15	2.31	1.66	1.14	0.72	0.38	0.09	
CL6 SMOOTH POLE																	
CL60S	9'10"	25.5"	17"	4	3/4"	4"	0.125	8'0"	7.68	6.89	5.60	4.60	3.80	3.16	2.63	2.19	1.83
CL61S	10'10"	25.5"	17"	4	3/4"	4"	0.125	9'0"	6.64	5.92	4.76	3.85	3.13	2.55	2.08	1.68	1.35
CL62S	11'10"	25.5"	17"	4	3/4"	4"	0.125	10'0"	5.74	5.10	4.03	3.21	2.55	2.02	1.59	1.23	0.93
CL63S	12'10"	25.5"	17"	4	3/4"	4"	0.125	11'0"	4.97	4.37	3.40	2.64	2.03	1.55	1.15	0.82	0.54
CL64S	13'10"	25.5"	17"	4	3/4"	4"	0.125	12'0"	4.28	3.73	2.83	2.12	1.57	1.12	0.75	0.44	0.19
CL65S	14'10"	25.5"	17"	4	3/4"	4"	0.125	13'0"	3.66	3.15	2.31	1.66	1.14	0.72	0.38	0.09	
CL7 SMOOTH POLE																	
CL70S	9'10"	24"	20"	4	3/4"	5"	0.188	8'0"	17.19	15.53	12.81	10.69	9.01	7.65	6.54	5.62	4.85
CL71S	10'10"	24"	20"	4	3/4"	5"	1.188	9'0"	15.17	13.66	11.20	9.29	7.77	6.54	5.54	4.71	4.01
CL72S	11'10"	24"	20"	4	3/4"	5"	2.188	10'0"	13.46	12.09	9.84	8.09	6.71	5.59	4.67	3.91	3.28
CL73S	12'10"	24"	20"	4	3/4"	5"	3.188	11'0"	11.99	10.73	8.66	7.05	5.78	4.75	3.91	3.21	2.63
CL74S	13'10"	24"	20"	4	3/4"	5"	4.188	12'0"	10.70	9.53	7.62	6.14	4.96	4.00	3.22	2.58	2.04
CL75S	14'10"	24"	20"	4	3/4"	5"	5.188	13'0"	9.56	8.47	6.70	5.31	4.21	3.33	2.60	2.00	1.50
CL8 SMOOTH POLE																	
CL80S	9'4"	19"	17"	3	3/4"	4"	0.125	8'0"	7.63	6.85	5.56	4.56	3.77	3.13	2.60	2.17	1.81
CL81S	10'4"	19"	17"	3	3/4"	4"	0.125	9'0"	6.60	5.89	4.73	3.82	3.11	2.53	2.05	1.66	1.33
CL82S	11'4"	19"	17"	3	3/4"	4"	0.125	10'0"	5.71	5.06	4.01	3.18	2.53	2.00	1.57	1.21	0.91
CL83S	12'4"	19"	17"	3	3/4"	4"	0.125	11'0"	4.94	4.34	3.37	2.61	2.01	1.53	1.13	0.80	0.53
CL84S	13'4"	19"	17"	3	3/4"	4"	0.125	12'0"	4.25	3.70	2.80	2.10	1.55	1.10	0.73	0.43	0.17
CL85S	14'4"	19"	17"	3	3/4"	4"	0.125	13'0"	3.64	3.13	2.29	1.64	1.12	0.70	0.36	0.08	

NOTES

- The pole material is aluminum extrusion per ASTM B221 alloy 6005 Temper T5 (35 ksi yield strength min, 15 ksi at welds per Table A.3.5 of the Aluminum Design Manual, 2010).
- The pole is welded onto a cast aluminum base. Construction of the pole is continuous, with the exception of AB4, which requires a hand hole.
- The maximum allowable EPA for signage is derived from:
 - The maximum allowable bending stress at the welded joint between the pole and the base,
 - The maximum deflection at the top end of the pole being $\leq 5\%$ of the exposed pole length with a 100-lb force applied at the top of pole, and
 - The projected area of pole and sign combined.
- The geometric center of the light fixture area is along the centerline of the light pole (i.e. symmetric wind loading) and centered at height, H plus half of the fixture height, above the ground.
- The fixture is defined as the structure mounted to the top of the light pole.
- The fixture height is assumed to be 38 in.
- Pole bases and anchorage are to be engineered by others.
- Reference ASCE 7-10 for wind forces. Exposure C category. Consult ASCE 7-10 for basic wind speeds in the desired site locations.
- The lights are not located near ridges, escarpments, or axisymmetric hills. Consult with an engineer for these applications.
- Local codes and standards applied by others.
- View the wind zone map of the US here: BrandonIndustries.com/EPA-Wind/