



BRANDON[®]
INDUSTRIES

1601 Wilmeth Road
McKinney, Texas 75069
Phone: 972.542.3000
Toll Free: 800.247.1274
brandonindustries.com

Complete Sign Unit SPF4-2A

made from the following parts:

POLE:

PART# SPF4X14
4" x 14' FLUTED POLE
WALL THICKNESS .125"

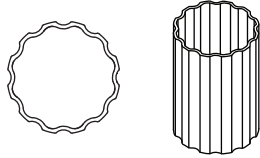

FINIAL:

PART# FIN-B4
BALL FINIAL
HEIGHT: 7.2"
WIDTH: 5.3"

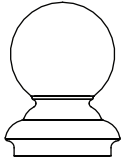

SIGNS:

PART# HI 0636DS
6" x 36" STREET SIGN, 4" LETTERS, HIP VINYL



PART# 0606DS LOGO
6" x 6" LOGO SIGN

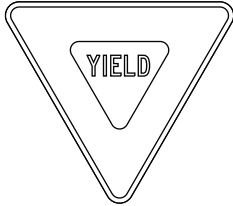

PART# HI R1-2/36
36" YIELD SIGN, HIP VINYL

TRIMS:

PART# TDS0636
FOR 6" x 36" STREET SIGN

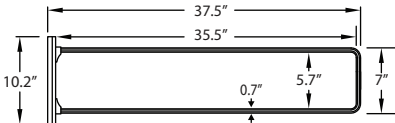

PART# TDS0606
FOR 6" x 6" LOGO SIGN

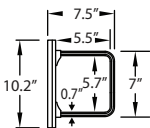

PART# TYIELD36
FOR 36" YIELD SIGN

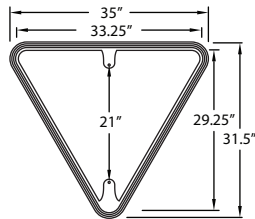

BASE:

PART# SB-64
TWO-PIECE BASE
HEIGHT: 18"
WIDTH: 13"

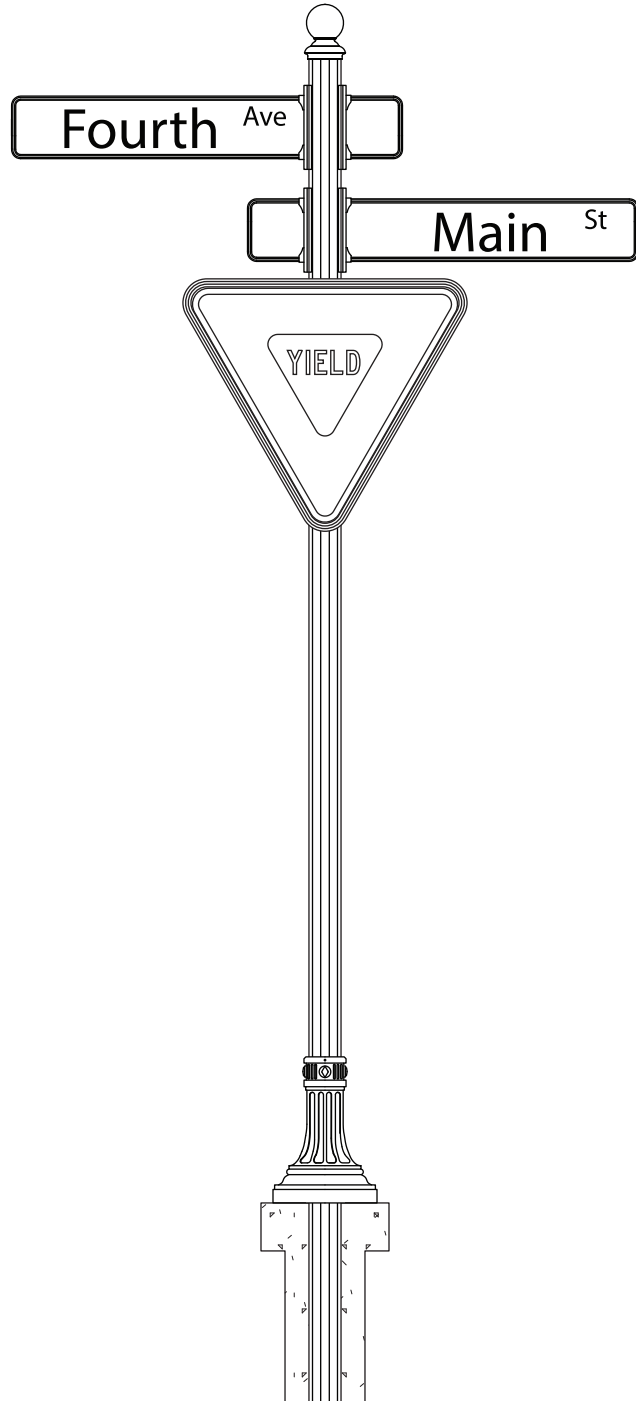
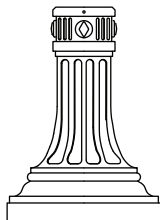

NOTES:
COMPLETE UNIT SHOWN WITH 2' BELOW GRADE BURIAL. FOUNDATION SHOULD BE DESIGNED TO MEET LOCAL CODES AND THE REQUIREMENTS OF SOIL CONDITIONS. DRAWING FOR INFORMATION ONLY, NOT INTENDED FOR CONSTRUCTION PURPOSES.

REV 08132020