



BRANDON[®]
INDUSTRIES

1601 Wilmeth Road
McKinney, Texas 75069
Phone: 972.542.3000
Toll Free: 800.247.1274
brandonindustries.com

Complete Sign Unit SPQ3-2A

made from the following parts:

POLE:

PART# SPQ3X14
3" x 14" SQUARE POLE
WALL THICKNESS .125"

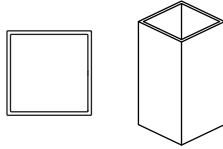

FINIAL:

PART# FINQ-C3
CAP FINIAL
HEIGHT: 2"
WIDTH: 4.5"

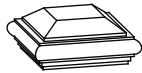

SIGNS:

PART# HI 0942DS
9" x 42" STREET SIGN, 6" LETTERS, HIP VINYL



PART# HI R1-2/36
36" YIELD SIGN, HIP VINYL

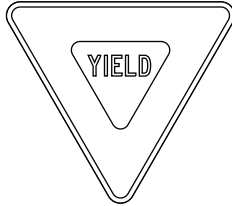

BRACKETS:
PART# 2WAYARM24
FOR STREET SIGN

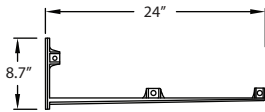

PART# TYIELD36
FOR 36" YIELD SIGN

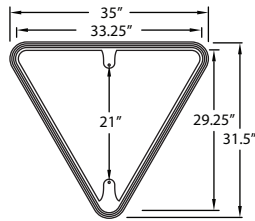

BASE:

PART# SBQ-13
SLIP OVER BASE
HEIGHT: 3"
WIDTH: 8"

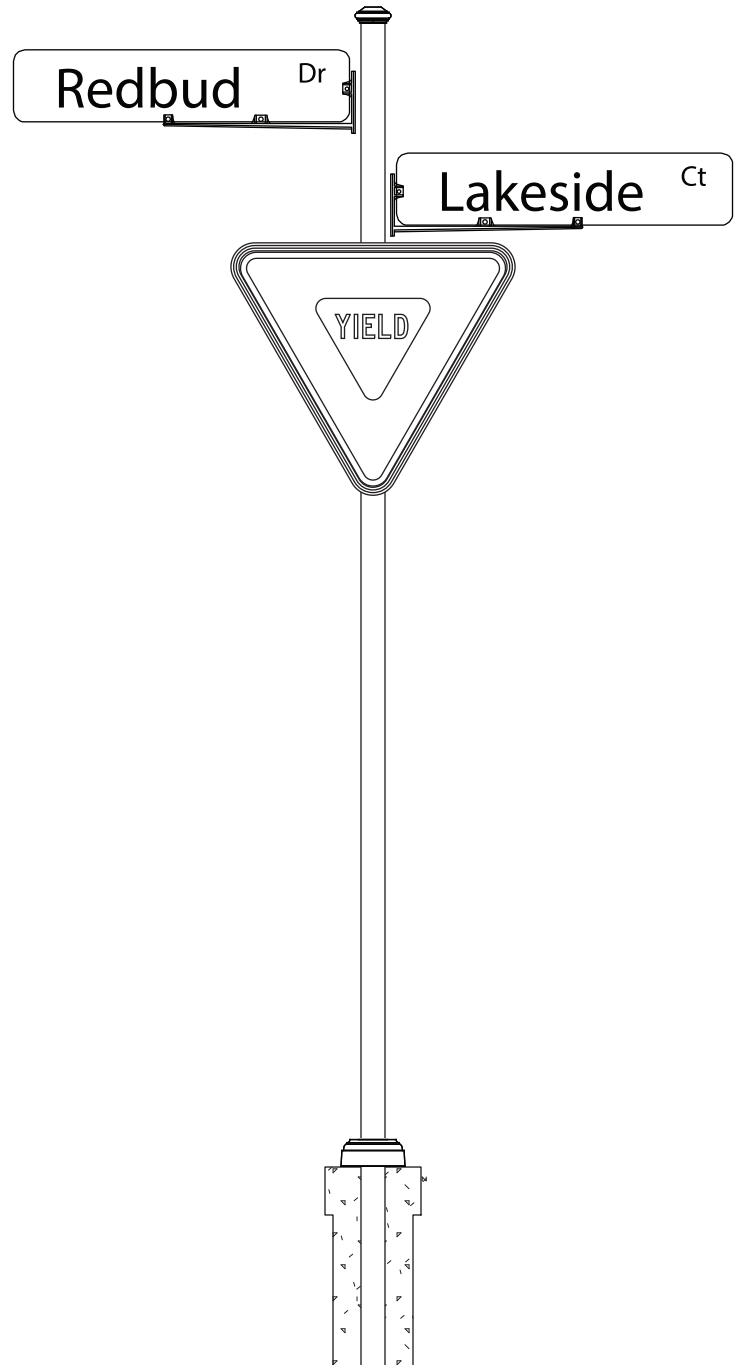
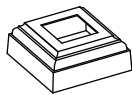

NOTES:
COMPLETE UNIT SHOWN WITH 2' BELOW GRADE BURIAL. FOUNDATION SHOULD BE DESIGNED TO MEET LOCAL CODES AND THE REQUIREMENTS OF SOIL CONDITIONS. DRAWING FOR INFORMATION ONLY, NOT INTENDED FOR CONSTRUCTION PURPOSES.

REV 08132020