



**BRANDON**<sup>®</sup>  
INDUSTRIES

1601 Wilmeth Road  
McKinney, Texas 75069  
Phone: 972.542.3000  
Toll Free: 800.247.1274  
brandonindustries.com

## Complete Sign Unit SPQ4-4A

made from the following parts:

### POLE:

PART# SPQ4X12  
4" x 12" SQUARE POLE  
WALL THICKNESS .125"

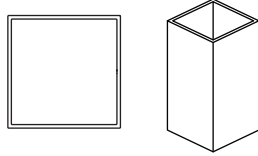

### FINIAL:

PART# FINQ-B4  
BALL FINIAL  
HEIGHT: 6"  
WIDTH: 4.5"

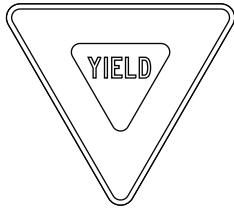
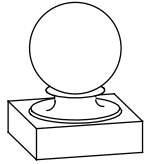

PART# HI R1-2/36  
36" YIELD SIGN, HIP VINYL

PART# TYIELD36  
FOR 36" YIELD SIGN

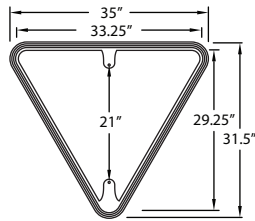

### BASE:

PART# 2PCQ-4  
TWO-PIECE BASE  
HEIGHT: 19.7"  
WIDTH: 8"

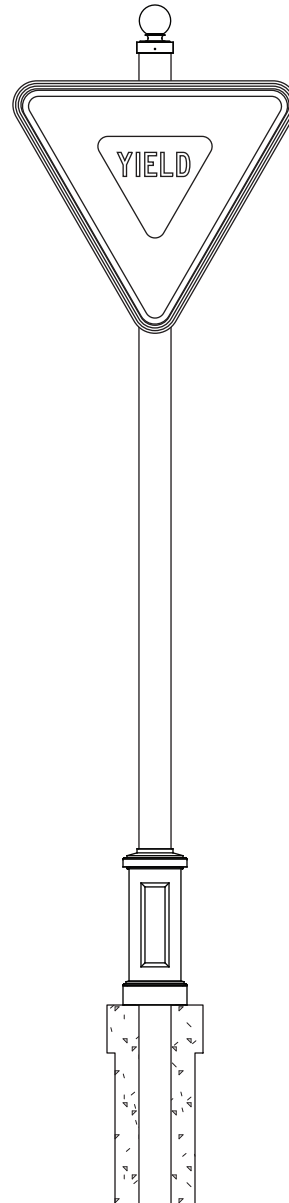
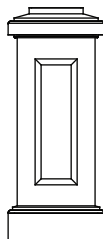

NOTES:  
COMPLETE UNIT SHOWN WITH 2' BELOW GRADE BURIAL. FOUNDATION SHOULD BE DESIGNED TO MEET LOCAL CODES AND THE REQUIREMENTS OF SOIL CONDITIONS. DRAWING FOR INFORMATION ONLY, NOT INTENDED FOR CONSTRUCTION PURPOSES.

REV 08132020